

Install 2 screws into the screw holes in the junction box.

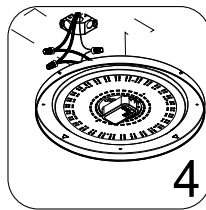

Connect black, white and green wire from the fixture to black/live, white/neutral and green/ground wire from the outlet box correspondingly. Secure wires together with wire nuts. If no ground wire is present, consult a qualified electrician.

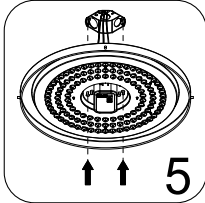

Align key slot holes on fixture with fixture screws, push up and twist.

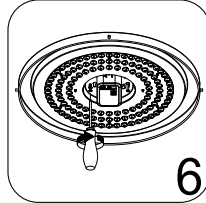

Screw fixture to ceiling. Do not touch LED chips during this step.

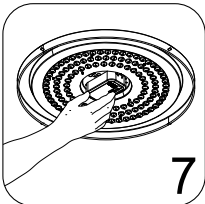

Move the switch to select your desired color temperature.

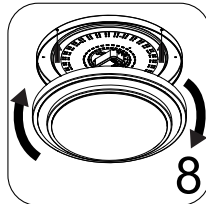

Align the four tabs on the fixture plate with the slots on shade. Twist shade clockwise until it stops.

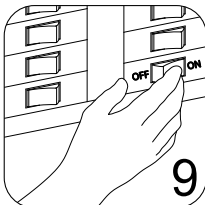

Restore power to the lighting system.



# Installation Guide

## LED Flush Mount Ceiling Light

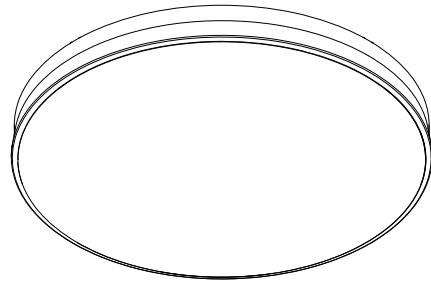

GE Lighting, a Savant company • 1-800-435-4448 • [www.gelighting.com](http://www.gelighting.com)

GE and C by GE are trademarks of General Electric Company. Used under trademark license.

INFORMATION PROVIDED IS SUBJECT TO CHANGE WITHOUT NOTICE. ALL VALUES ARE DESIGN OR TYPICAL VALUES WHEN MEASURED UNDER LABORATORY CONDITIONS.

©2024 GE Lighting, a Savant company.

PK-00104607-4 4

## PRODUCT COVERED

Model	Input voltage (Vac, Hz)	Current (mA)	Wattage (W)
FLM19DW240D95CWTNG2	120, 60	300	33

## DIMMING

The luminaire is dimmable with most regular dimmers.



### BEFORE YOU BEGIN

Read these instructions completely and carefully.

## WARNING

- Risk of fire or electric shock. LED ceiling light installation requires knowledge of luminaires electrical systems. If not qualified, do not attempt installation. Contact a qualified electrician.
- Risk of fire or electric shock. Install this luminaire only in junction box that have the construction features and dimensions shown in the photographs and/or drawings and where the input rating does not exceed the input rating of the luminaire.
- To prevent wiring damage or abrasion, do not expose wiring to edges of sheet metal or other sharp objects.
- This device is not intended for use with emergency exits.

These products are intended for used in dry or damp locations.

Min 90°C (194°F) supply conductors suitable for operation in an ambient not exceeding 40°C (104°F).

This device complies with Part 15 of the FCC Rules. Operations is subject to the following two conditions: (1) This device may not cause harmful interference. And (2) this device must accept any interference received, including interference that may cause undesired operation. This device complies with CAN ICES-005 B.

NOTE: This equipment has been tested and found to comply with the limits for a Class B digital device, pursuant to part 15 of the FCC Rules. These limits are designed to provide reasonable protection against harmful interference in a residential installation. This equipment generates, uses and can radiate radio frequency energy and, if not installed and used in accordance with the instructions, may cause harmful interference to radio communications. However, there is no guarantee that interference will not occur in a particular installation. If this equipment does cause harmful interference to radio or television reception, which can be determined by turning the equipment off and on, the user is encouraged to try to correct the interference by one or more of the following measures: reorient or relocate the receiving antenna, increase the separation between the equipment and receiver, connect the equipment into an outlet on a circuit different from that to which the receiver is connected, consult the dealer or an experienced radio/TV technician for help.

## PREPARE ELECTRICAL WIRING



### Electrical Requirements

The LED fixture must be supplied with 120VAC 60Hz.



### Grounding Instructions

The grounding and bonding of the overall system shall be done in accordance with National Electric Code (NEC) Article 600 and local codes.

## PACKAGE CONTENTS

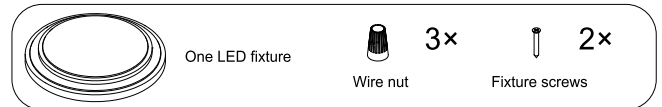

## TOOLS REQUIRED



Risk of Damage: Must use UL approved conduit fittings for all enclosure box connections to prevent wire cuts by sharp edges and excessive strain on wiring.

## INSTALLATION

This fixture is designed to be mounted to a junction box with a screw hole spacing of 2.75" (70mm) or 3.50" (90mm).

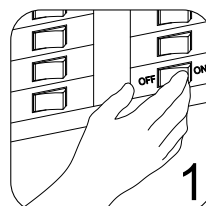

Turn off power source.

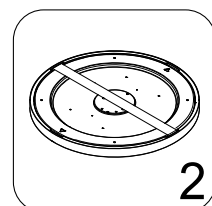

Pull out the base plate from the fixture and remove the paper backing from the base plate.